



Redmayne Arnold & Harris
estate agents, letting agents & surveyors

rah.co.uk



TO LET



Glyndebourne Fowlmere Road, Thriplow, Royston, SG8 7QU

£2,600 PCM



THE PROPERTY

A beautifully presented four bedroom detached house close to the centre of this sought-after South Cambridgeshire village, offering access to Addenbrookes Hospital, mainline station, City Centre and M11.

The property comprises of an entrance hall, large kitchen/breakfast room with bifold doors to the garden and a wood-burner, utility room, downstairs W/C, sitting room with bifold doors out to garden, dining room and playroom/study. Upstairs there are four bedrooms with built-in storage. Two bedrooms benefit from en-suite shower rooms and there is also a contemporary family bathroom.

To the front of the property there is off-street parking and to the rear is an enclosed garden with planted borders, mainly laid to lawn with a large patio area.

Council Tax Band F.

EPC Rating D.

Deposit £3000

Holding Deposit: £390

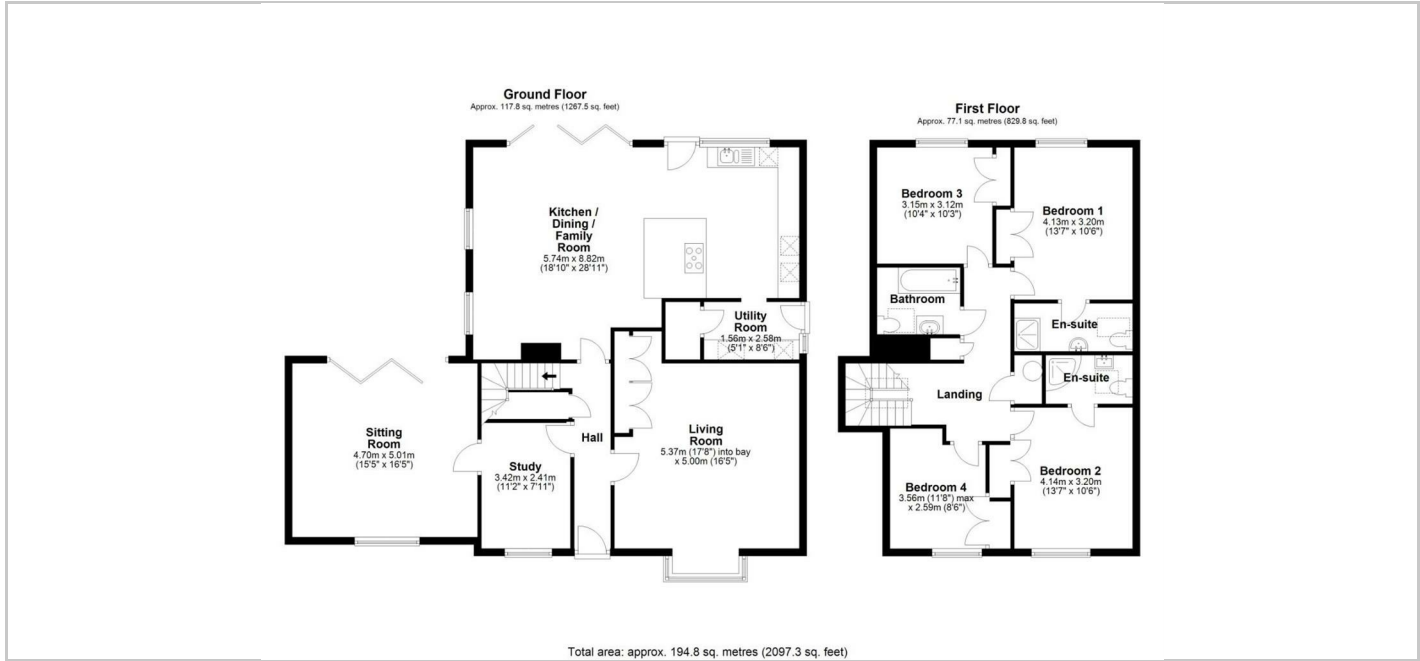

SITUATION

Directions

